

DIMENSIONS

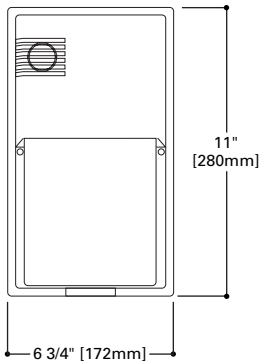

MOUNTING DETAILS

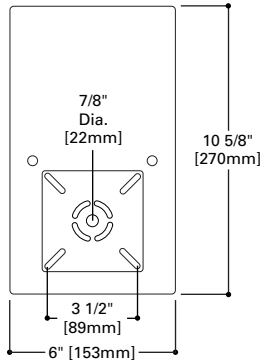

DESCRIPTION

The Lumark WAL-LITE features a injection-molded polycarbonate housing / lens and a die-cast aluminum back plate for rugged durability. U.L. Listed for wet locations. CSA certified.



WM WAL-LITE

35 - 70 W

High Pressure Sodium

**COMPACT WALL MOUNT
LUMINAIRE**

ORDERING INFORMATION

SAMPLE NUMBER: HPWM70

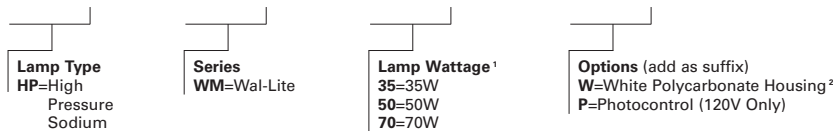

- Die-cast aluminum back plate
- Injection-molded polycarbonate housing. Standard color bronze. Optional white finish available
- Aluminum reflector and prismatic refractor directs light down and out, reducing glare and wasted light
- Housing is sealed and gasketed
- 1/2" NPS entry point for direct mount applications where internal wiring is desired
- Can be mounted to any vertical surface
- U.L. listed for wet locations. CSA certified
- Approximate net weight: 7 lbs. (3 kgs.)

NOTES: 1 All lamps are medium-base. Lamp is included. 2 HPWM35W not available. 3 For complete product data, reference the Lumark Specification binder. 4 Specifications and dimensions subject to change without notice. 5 Products also available in non-US voltages and frequencies for international markets. 6 Consult your Cooper Lighting Representative for availability and ordering information.